

PIN	DIM.A	DIM.B	PIN	DIM.A	DIM.B
02	3.96	7.92	09	31.68	35.86
03	7.92	11.92	10	35.64	39.90
04	11.88	15.84	11	39.60	43.84
05	15.84	19.84	12	43.56	47.92
06	19.80	23.80	13	47.52	51.72
07	23.76	27.88	14	51.48	55.92
08	27.72	31.74			

REV	MODIFICATION	DATE	DRAW
A4	Modify Outline	2009.01.13	Abel
A5	Release To ECN20130208	2013.02.27	Seven
B0	Release To ECN20150108	2015.01.22	Michelle

RoHS Compliant

Specification

- 1.Current Rating:7A
- 2.Voltage Rating:250V AC/DC
- 3.Contact Resistance:10mΩ Max.
- 4.Insulation Resistance:1000MΩ Min. At DC 500V
- 5.Dielectric Withstanding Voltage:AC1500V/Minute
- 6.Operating Temperature:-25℃~+85℃

Material:

- 1.Housing:Thermoplastic UL94V-0
- 2.Contact Pin:Copper Alloy SQ. Pin 1.14mm

Finish:

- 1.Housing:Nature
- 2.Contact Pin:See P/N Option

Part No.: AD02200 XX X X 5 2

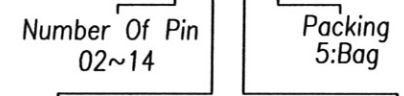

Housing Material

- 1:NY66 UL94V-0 Natural
- 4:NY66+GF. UL94V-0 Nature

Plating

- 1:Bright Tin Plated Over Ni (For NY66 UL94V-0)
- 2:Matte Tin Plated Over Ni (For NY66+GF. UL94V-0)

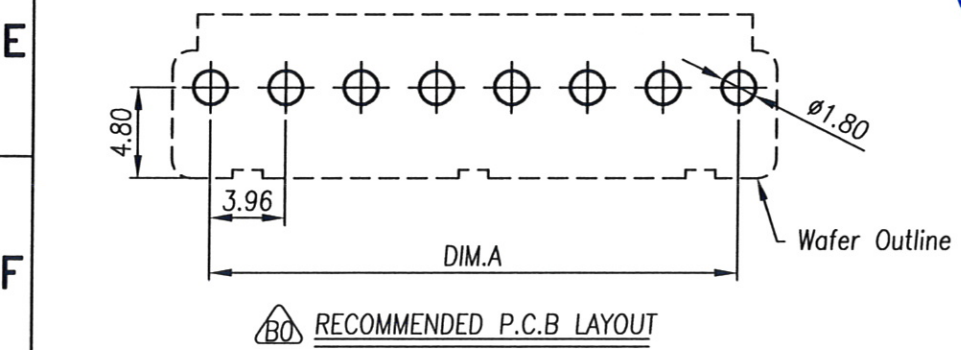
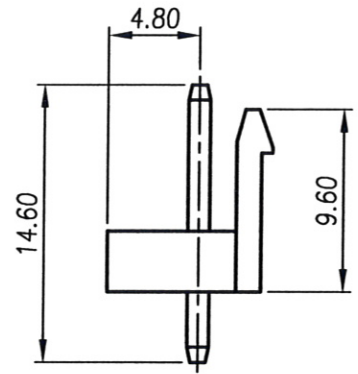
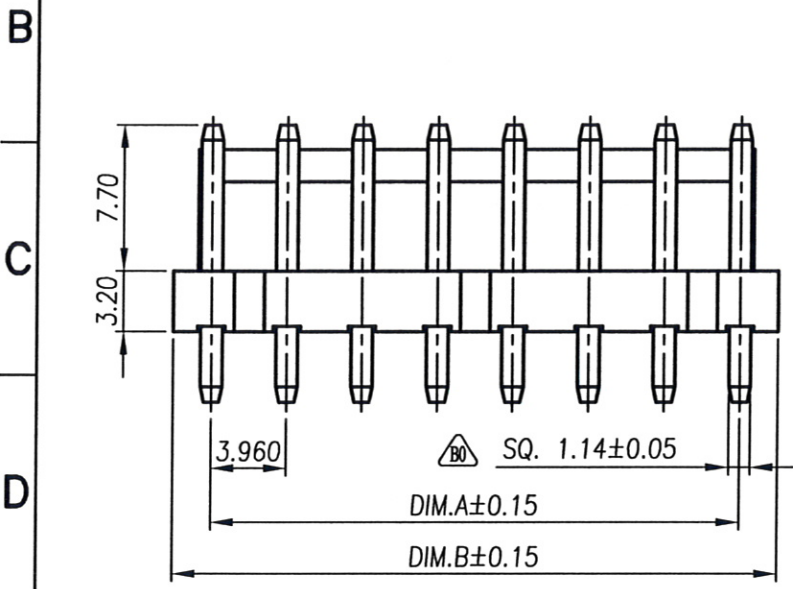

		金上達科技股份有限公司 GOLDENSUNDA TECHNOLOGY CO.,LTD			
		TOLERANCE UNLESS OTHERWISE SPECIFIED			
PROJ.	TITLE: Wire To Board Wafer 3.96mm 180' DIP Single Row			PART NO. AD02200XXXX52	DWG NO. AD02200XXXX52
.x± 0.35	x.'± 2'	APR. C.F.Liao 20150122	UNITS: mm		CUSTOMER DRAWING
.xx± 0.25	.x'± 1'	CHK. Abel 20150122	SIZE: A4	SCALE 2.5:1	
.xxx± 0.15	.xx'± 0.5'	DRA. Michelle 20150122	SHEET 1 / 1	REV B0	V