



RoHS Compliant

| REV | MODIFICATION           | DATE       | DRAW  |
|-----|------------------------|------------|-------|
| A0  | Release To Production  | 2010.01.18 | AJ    |
| A1  | Release To ECN20110809 | 2011.09.09 | Ivy   |
| A2  | Release To ECN20130208 | 2013.02.27 | Seven |



Specification

- 1.Current Rating:7A
- 2.Voltage Rating:250V AC/DC
- 3.Contact Resistance:10mΩ Max.
- 4.Insulation Resistance:1000MΩ Min. At DC 500V
- 5.Dielectric Withstanding Voltage:1500 VAC/Minute
- 6.Operating Temperature:-25℃~+85℃

Material:

- 1.Housing:Thermoplastic UL94V-2
  - 2.Contact Pin:Copper Alloy SQ Pin=1.14mm
- Finish:
- 1.Housing:Natural
  - 2.Contact Pin:Bright Tin Plated Over Nickel.

Part No.: AD02101 XX 0 1 5 2

Number of Pin  Packing  
02~16  5:Bag

Housing Material  Plating  
0:NY66 UL94V-2 Natural  1:Bright Tin Plated Over Ni

| PIN | DIM.A | DIM.B | PIN | DIM.A | DIM.B |
|-----|-------|-------|-----|-------|-------|
| 02  | 3.96  | 8.00  | 10  | 35.64 | 39.90 |
| 03  | 7.92  | 12.00 | 11  | 39.60 | 43.90 |
| 04  | 11.88 | 15.90 | 12  | 43.56 | 47.80 |
| 05  | 15.84 | 20.00 | 13  | 47.52 | 51.80 |
| 06  | 19.80 | 24.00 | 14  | 51.48 | 55.70 |
| 07  | 23.76 | 27.90 | 15  | 55.44 | 59.80 |
| 08  | 27.72 | 31.90 | 16  | 59.40 | 63.80 |
| 09  | 31.68 | 35.80 |     |       |       |

A

B

C

D

E

F

A

B

C

D

E

F

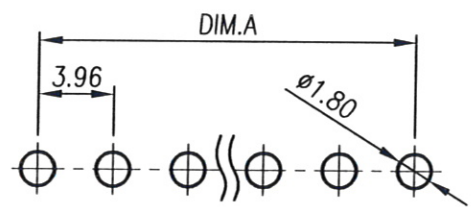
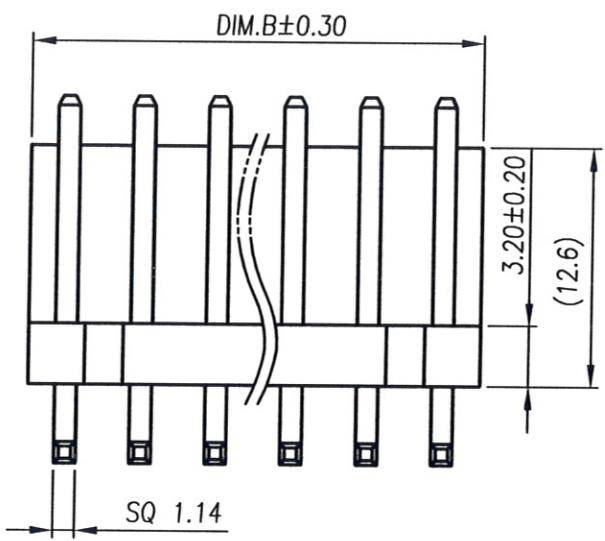
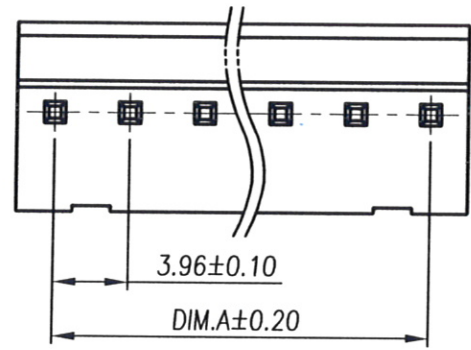

RECOMMENDED PCB LAYOUT  
(Tolerance:±0.05)

**金上達科技股份有限公司**  
GOLDENSUNDA TECHNOLOGY CO.,LTD

|                                      |            |                        |   |                       |             |
|--------------------------------------|------------|------------------------|---|-----------------------|-------------|
| TOLERANCE UNLESS OTHERWISE SPECIFIED |            | PROJ.                  | TITLE: Wire To Board Wafer 3.96mm 90° DIP |                       |             |
| .x± 0.35                             | x.*± 2'    | APR. Jay 20130227      | PART NO. AD02101XX0152                    | DWG NO. AD02101XX0152 |             |
| .xx± 0.25                            | .x*± 1'    | CHK. Michelle 20130227 | UNITS: mm                                 | CUSTOMER DRAWING      |             |
| .xxx± 0.15                           | .xx*± 0.5' | DRA. Seven 20130227    | SIZE: A4                                  | SCALE 2.5:1           | SHEET 1 / 1 |
|                                      |            |                        | REV A2                                    | V                     |             |

1 2 3 4 5 6 7 8