

RoHS Compliant

REV	MODIFICATION	DATE	DRAW
A0	Release To Production	2010.01.28	AJ
A1	Release To ECN20130303	2013.03.12	Seven
A2	Release To ECN20130406	2013.04.16	Seven

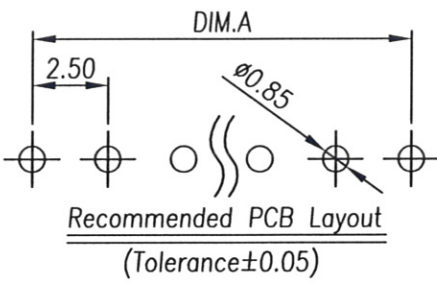
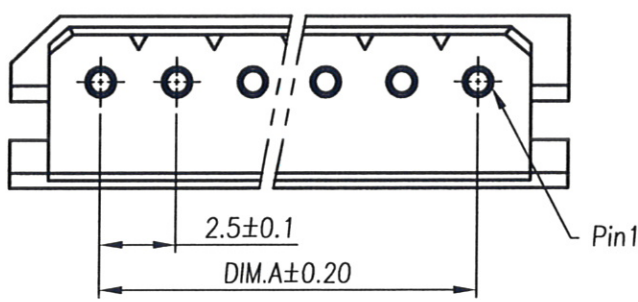

Specification
 1.Current Rating:3A AC/DC
 2.Voltage Rating:250V AC/DC
 3.Contact Resistance:20mΩ Max.
 4.Insulation Resistance:1000MΩ Min. At DC 500V
 5.Dielectric Withstanding Voltage:1000V AC/Minute
 6.Operating Temperature:-25°C~+85°C

Material:
 1.Housing:High-Temp. Thermoplastic UL94V-0
 2.Contact Pin:Copper Alloy Ø0.70mm
 Finish:
 1.Housing:Natural
 2.Contact Pin:Bright Tin Over Nickel
 Part No.: AD05000 XX 1 1 5 6
 Number Of Pin 02~16
 Housing Material 1:NY66 UL94V-0 Nature
 Packing 5:Bag
 Plating 1:Bright Tin Plated Over Ni.

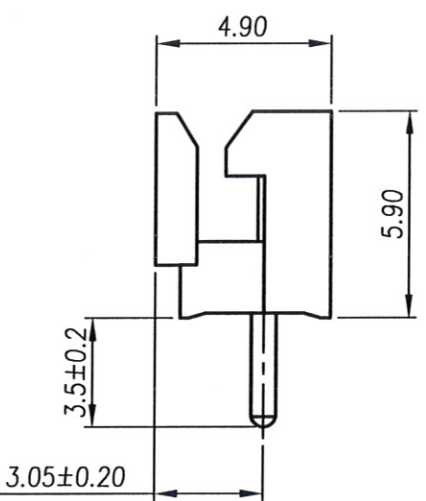
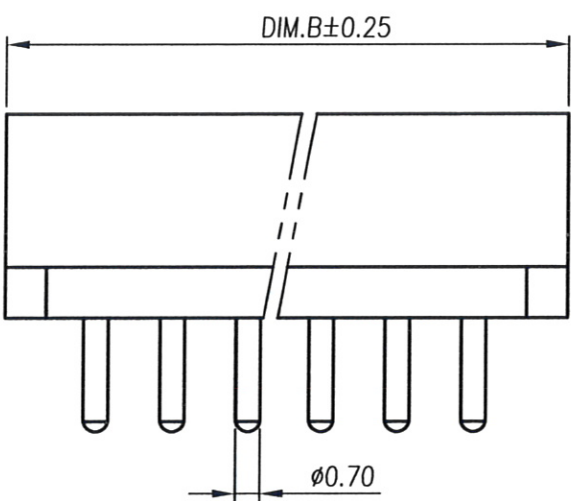

發行
 102. 4. 26
 文管中心

A2

PIN	DIM.A	DIM.B	PIN	DIM.A	DIM.B
02	2.50	7.50	10	22.50	27.50
03	5.00	10.00	11	25.00	30.00
04	7.50	12.50	12	27.50	32.50
05	10.00	15.00	13	30.00	35.00
06	12.50	17.50	14	32.50	37.50
07	15.00	20.00	15	35.00	40.00
08	17.50	22.50	16	37.50	42.50
09	20.00	25.00			

金上達科技股份有限公司
GOLDENSUNDA TECHNOLOGY CO.,LTD

TITLE: Wire To Board Wafer 2.50mm 180' DIP

TOLERANCE UNLESS OTHERWISE SPECIFIED	PROJ.	APR. Jay 20130416	PART NO. AD05000XX1156	DWG NO. AD05000XX1156
.x± 0.35	x.± 2'	CHK. Michelle 220130416	UNITS: mm	CUSTOMER DRAWING
.xx± 0.25	.x± 1'	DRW. Seven 20130416	SIZE: A4	SCALE 4:1
.xxx± 0.15	.xx± 0.5'		SHEET 1 / 1	REV A2 V