

1 2 3 4 5 6 7 8

RoHS Compliant

REV	MODIFICATION	DATE	DRAW
A0	Release To Production	2009.09.28	Abel
A1	Release To ECN20130303	2013.03.12	Seven

A
B
C
D
E
F

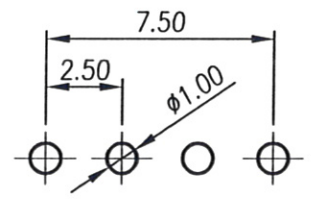
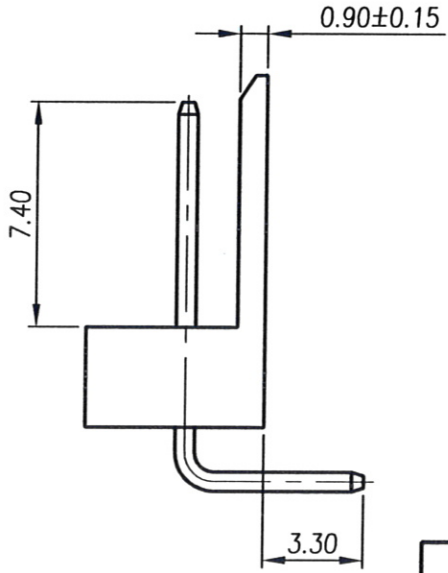
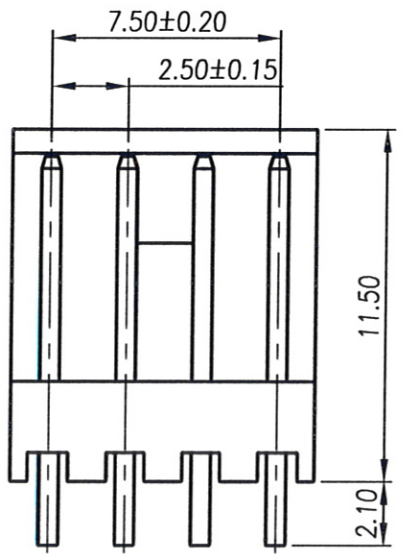
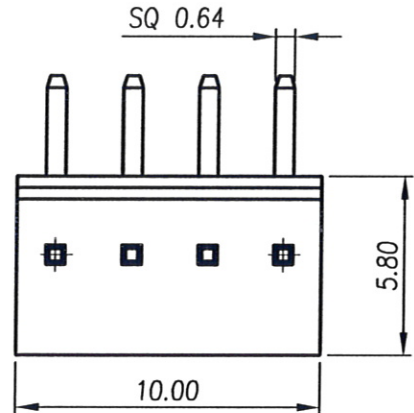

Recommended PCB Layout
(Tolerance ±0.05)

Specification

- 1.Current Rating:3A AC/DC
- 2.Voltage Rating:250V AC/DC
- 3.Contact Resistance:20mΩ Max.
- 4.Insulation Resistance:1000MΩ Min. At DC 500V
- 5.Dielectric Withstanding Voltage:AC 800V/Minute
- 6.Operating Temp.:−25°C~+85°C

Material:

- 1.Housing:High-Temp. Thermoplastic UL94V-0
- 2.Contact Pin:Copper Alloy SQ Pin=0.64mm

Finish:

- 1.Housing:Natural
- 2.Contact Pin:Bright Tin Over Nickel

Part No.: ADO4901 04 1 1 5 2

Number Of Pin 04
 Housing Material 1:PA66 UL94V-0 Natural
 Plating 1:Bright Tin Plated Over Nickel
 Packing 5:Bag



		金上達科技股份有限公司 GOLDENSUNDA TECHNOLOGY CO.,LTD			
		TITLE: Wire To Board Wafer 2.50mm 90° DIP			
TOLERANCE UNLESS OTHERWISE SPECIFIED		PROJ.	PART NO. ADO4901041152		DWG NO. ADO4901041152
.x± 0.35	.x'± 2'	APR. Jay 20130312	CUSTOMER DRAWING		
.xx± 0.25	.x'± 1'	CHK. Michelle 20130312			
.xxx± 0.15	.xx'± 0.5'	DRA. Seven 20130212			
		UNITS: mm	SIZE: A4	SCALE 4:1	SHEET 1 / 1
		REV A1		V	

1 2 3 4 5 6 7 8