



RoHS Compliant

REV	MODIFICATION	DATE	DRAW
B1	Refer To ECN20140709	2014.07.29	Michelle
B2	Refer To ECN20140805	2014.08.29	Michelle
B3	Refer To ECN20150310	2015.03.19	Michelle

Specification

- 1.Current Rating:3A AC/DC
- 2.Voltage Rating:250V AC/DC
- 3.Contact Resistance:20mΩ Max.
- 4.Insulation Resistance:1000MΩ Min. At DC 500V
- 5.Dielectric Withstanding Voltage:AC800V/Minute
- 6.Operating Temperature:-25°C~+85°C

Material:

- 1.Housing:High Temperature Or Thermoplastic UL94V-0
- 2.Contact Pin:Copper Alloy SQ. Pin 0.64mm

Finish:

- 1.Housing:White
- 2.Contact Pin:See P/N Option

Part No.:AD04600 XX X 4 5 2

No. Of Pin
B2 02~14

Packing
5:Bag

Housing Material
1:Nylon66 UL94V-0 White
4:Nylon66+GF UL94V-0 White

Plating
4:Tin Plated Over Ni
With Kink



Notes:* Minimum order quantity limit, if there is demand, please contact business staff.



PIN	DIM.A	DIM.B
02	2.50	7.50
03	5.00	10.00
04	7.50	12.50
05	10.00	15.00
06	12.50	17.50
07	15.00	20.00
08	17.50	22.50
09	20.00	25.00
10	22.50	27.50
11	25.00	30.00
12	27.50	32.50
*13	30.00	35.00
*14	32.50	37.50

A

B

C

D

E

F

A

B

C

D

E

F

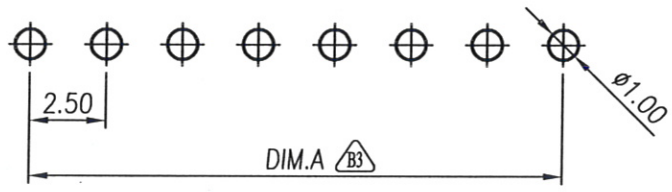
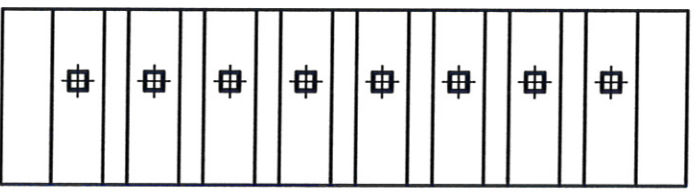
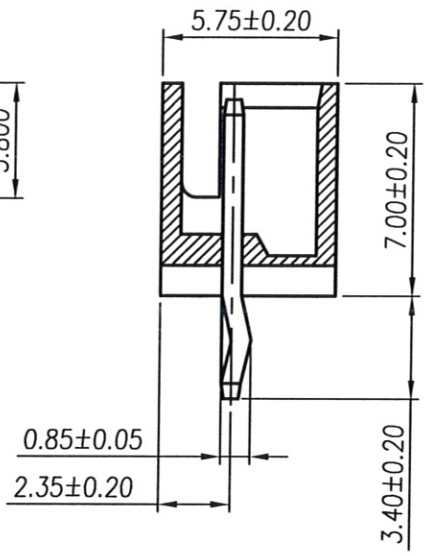
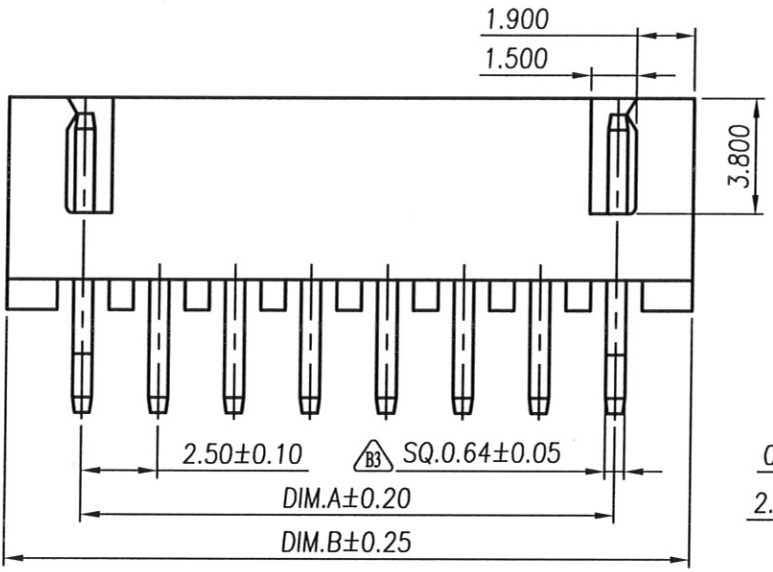
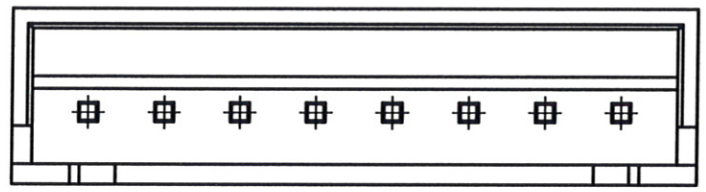

RECOMMENDED P.C.B LAYOUT



金上達科技股份有限公司 GOLDENSUNDA TECHNOLOGY CO.,LTD

TOLERANCE UNLESS OTHERWISE SPECIFIED		PROJ.	TITLE: Wire To Board Wafer 2.50mm 180° DIP Single Row With Kink	
.x± 0.35	.x'± 2'	APR. C.F.Liao 20150319	PART NO. AD04600XXX452	DWG NO. AD04600XXX452
.xx± 0.25	.x'± 1'	CHK. Abel 20150319	UNITS: mm	CUSTOMER DRAWING
.xxx± 0.15	.xx'± 0.5'	DRA. Michelle 20150319	SIZE: A4	SCALE 4:1
		SHEET 1 / 1		REV B3 V

1 2 3 4 5 6 7 8