

REV	MODIFICATION	DATE	DRAW
A0	Modify P/N NEW RULE	2009.03.04	Abel
A1	ECN20120803	2012.08.10	Michelle

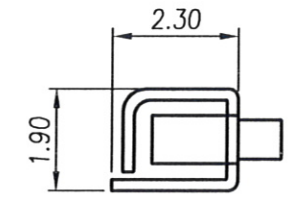
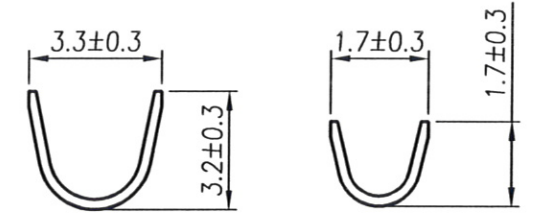
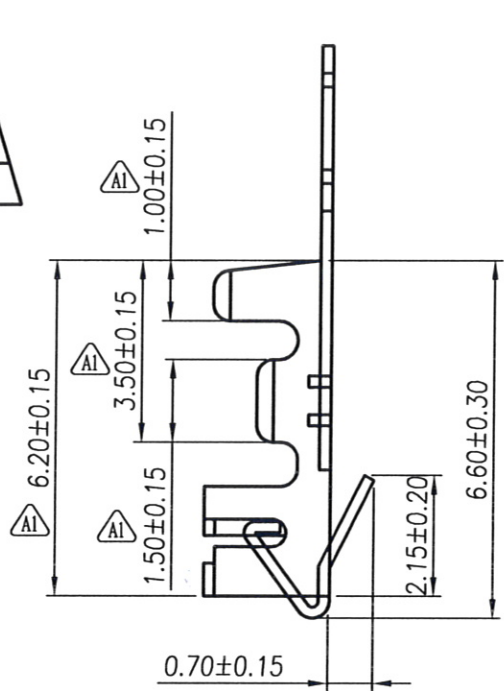
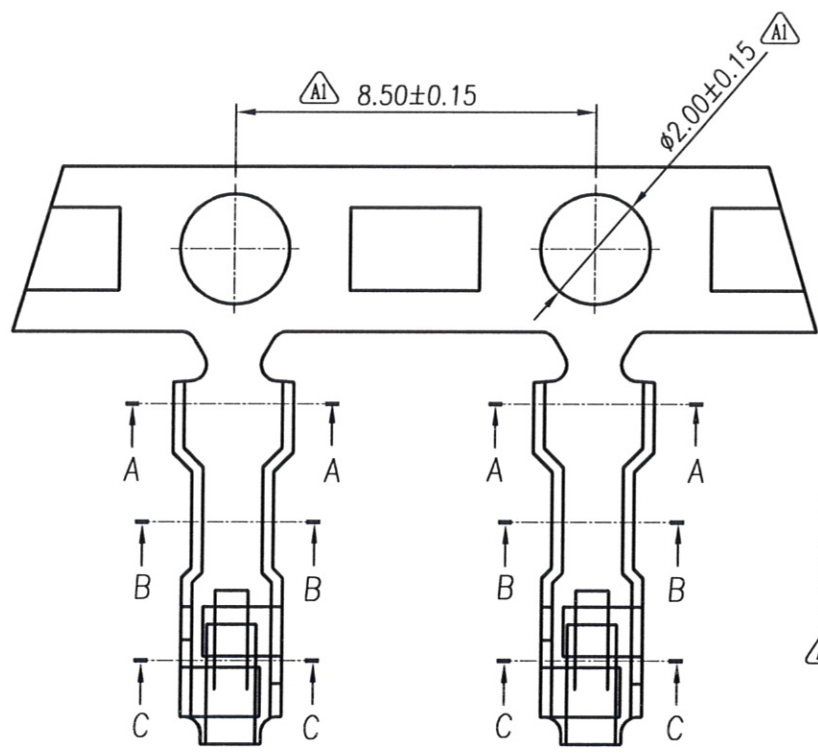

**RoHS Compliant**

Specifications & Ordering Information:

Part No	Thickness	Material	Wire Range	Insulation O.D.
CC0460000P1A5	0.20mm	Phosphor Bronze	AWG #22~28	φ1.90mm Max.

Finish	Q'TY/REEL
Bright-Tin Plated	8000PCS/REEL

**金上達科技股份有限公司**  
**GOLDENSUNDA TECHNOLOGY CO.,LTD**

TOLERANCE UNLESS OTHERWISE SPECIFIED		PROJ.	TITLE: Wire To Board Terminal 2.50mm		
.x± 0.35	x.'± 2'	APR. Jay 20120810	PART NO. CC0460000P1A5	DWG NO. CC0460000P1A5	
.xx± 0.25	.x'± 1'	CHK. Seven 20120810	UNITS: mm	CUSTOMER DRAWING	
.xxx± 0.15	.xx'± 0.5'	DRA. Michelle 20120810	SIZE: A4	SCALE 1.2:1	SHEET 1 / 1
			REV A1	V	