

**RoHS Compliant**

REV	MODIFICATION	DATE	DRAW
A0	Refer to MA20170503	20170531	Abel

Specification  
 1.Current Rating:1A AC/DC  
 2.Voltage Rating:50V AC/DC  
 3.Contact Resistance:30mΩ Max.  
 4.Insulation Resistance:100MΩ Min.  
 5.Withstand Voltage:AC500V/Minute  
 6.Operating Temperature:-25°C~+85°C  
 Material:

1.Housing:Thermoplastic UL94V-0  
 Finish:  
 1.Housing:Natural  
 Use With:  
 1.Terminal:CC0970008PAAV  
 Part No.:BC09700 XX 1 1 B V  
 No. Of Pin ———— 1 ———— Packing  
 02~15 ———— B:Bag  
 Housing Material ———— Housing Color  
 1:Nylon66 UL94V-0 1:Nature

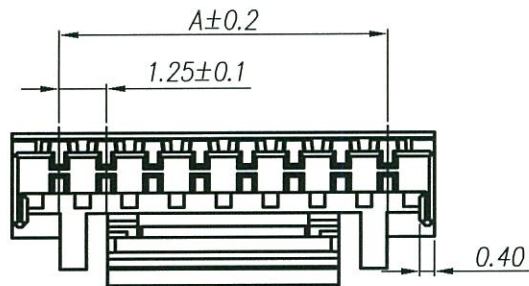
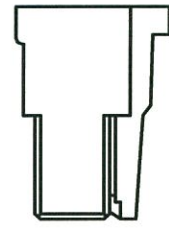
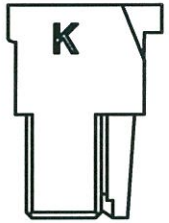
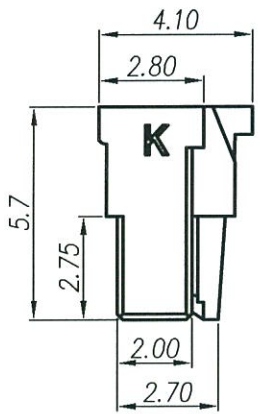
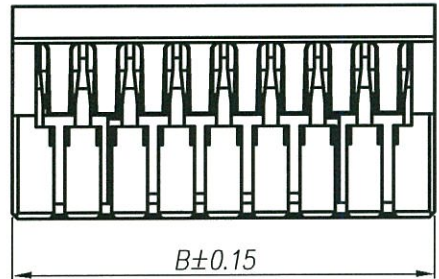
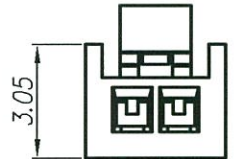
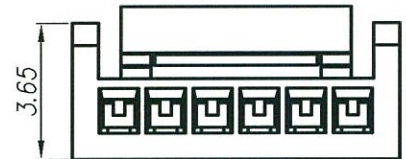
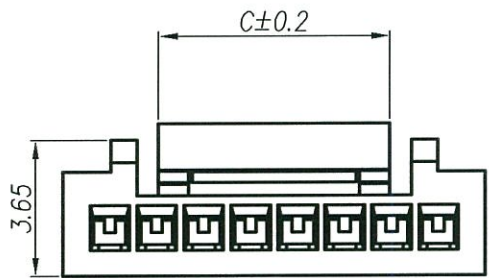

PIN	Dimensions		
	A	B	C
02	1.25	3.85	1.90
03	2.50	5.10	2.90
04	3.75	6.35	4.15
05	5.00	7.50	4.15
06	6.25	8.75	6.15
07	7.50	10.00	6.15
08	8.75	11.25	6.15
09	10.00	12.50	6.15
10	11.25	13.75	8.10
11	12.50	15.00	8.10
12	13.75	16.25	8.10
13	15.00	17.50	8.10
14	16.25	18.75	8.10
15	17.50	20.00	8.10

**金上達科技股份有限公司**  
**GOLDENSUNDA TECHNOLOGY CO.,LTD**

TOLERANCE UNLESS OTHERWISE SPECIFIED		PROV.	TITLE: Wire To Board Housing 1.25mm Male Single Row	
.x± 0.35	x.± 2'	APR. Jefferson 20170531	PART NO. BC09700XX11BV	DWG NO. BC09700XX11BV
.xx± 0.25	.x'± 1'	CHK.	UNITS: mm CUSTOMER DRAWING	
.xxx± 0.15	.xx'± 0.5'	DRA. Abel 20170531	SIZE: A4	SCALE FREE SHEET 1 / 1 REV A0 V