

1 2 3 4 5 6 7 8

A

B

C

D

E

F

A

B

C

D

E

F



RoHS Compliant

REV	MODIFICATION	DATE	DRAW
A0	Release To Production	2008.06.10	Ricky
A1	Modify P/N	2009.02.04	Abel
A2	Release To ECN20130308	2013.03.25	Seven

Specification

- 1.Current Rating:1A AC/DC
- 2.Voltage Rating:125V AC/DC
- 3.Contact Resistance:20mΩ Max.
- 4.Insulation Resistance:100MΩ Min.
- 5.Withstand Voltage:250V AC/Minute
- 6.Operating Temperature:-40°C~+85°C

Material:

1.Housing:Temperature Thermoplastic UL94V-0

Finish:

1.Housing:Natural

Part No.:BC07605 XX X 2 B 2

Number of Pin 02~15 Packing B:Bag

Housing Material

- 1:NY66 UL94V-0
- C:NU66 UL94V-0 Halogen Free

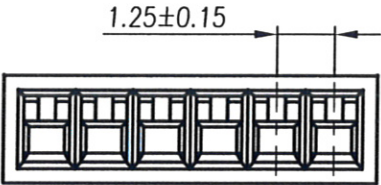

Recommended PCB Layout  
(Tolerance ±0.05)

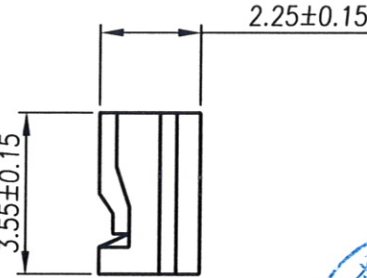
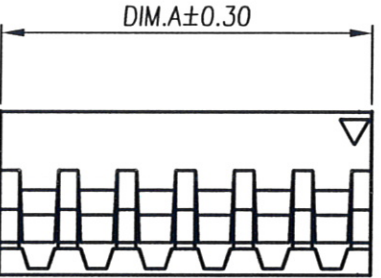

08	10.55	8.75	15	19.30	17.50
07	9.30	7.50	14	18.05	16.25
06	8.05	6.25	13	16.80	15.00
05	6.80	5.00	12	15.55	13.75
04	5.55	3.75	11	14.30	12.50
03	4.30	2.50	10	13.05	11.25
02	3.05	1.25	09	11.80	10.00
PIN	DIM.A	DIM.B	PIN	DIM.A	DIM.B

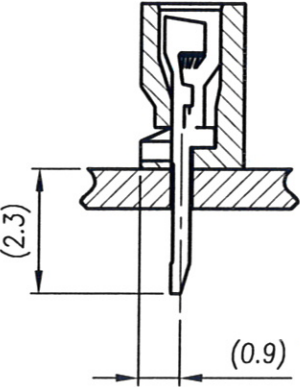
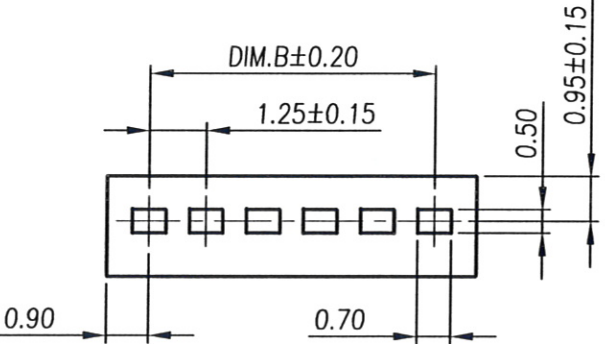

**金上達科技股份有限公司**  
GOLDENSUNDA TECHNOLOGY CO.,LTD

TOLERANCE UNLESS OTHERWISE SPECIFIED

.x± 0.35	x.'± 2'	APR. Jay 20130325	PROJ.	TITLE: Wire To Board Housing 1.25mm 180' Board In Type
.xx± 0.25	.x'± 1'	CHK. Michelle 20130325	PART NO. BC07605XXX2B2	DWG NO. BC07605XXX2B2
.xxx± 0.15	.xx'± 0.5'	DRA. Seven 20130325	UNITS: mm	CUSTOMER DRAWING

SIZE: A4 SCALE 6:1 SHEET 1 / 1 REV A2 V

1 2 3 4 5 6 7 8