



REV	MODIFICATION	DATE	DRAW
A0	Release To FAI20120161	2012.05.04	Seven
A1	Release To ECN20130506	2013.05.29	Michelle

**RoHS Compliant**

Specification

- 1.Current Rating:1A AC/DC
- 2.Contact Resistance:20mΩ Max.
- 3.Insulation Resistance:5000MΩ Min.
- 4.Dielectric Withstanding Voltage:500 VAC/Minute
- 5.Operating Temperature:-40°C~+105°C

Material:

- 1.Housing:High Temperature Thermoplastic UL94V-0
- 2.Contact Pin:Copper Alloy T=0.15mm

Finish:

- 1.Housing: Black
- 2.Contact Pin:Gold Flash Over Nickel.

Part No.: ES033D1 XX 4 3 T P

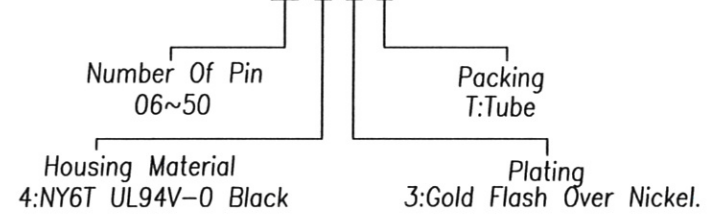

A

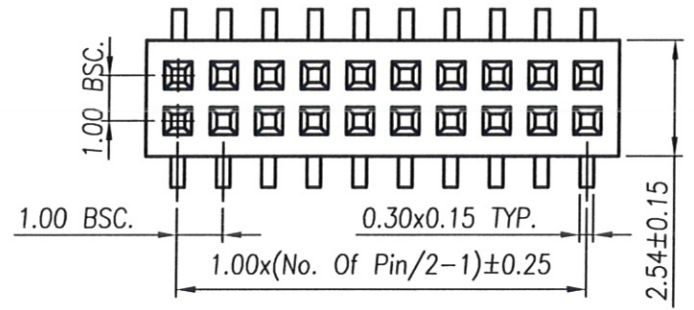

B

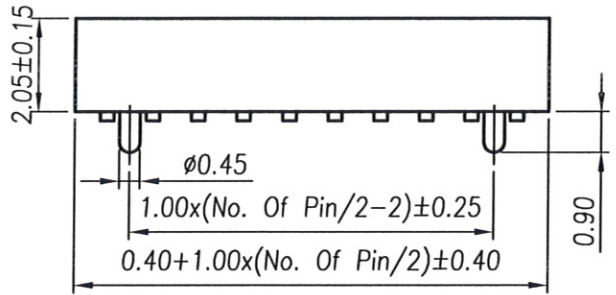

C

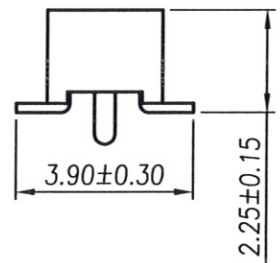

D

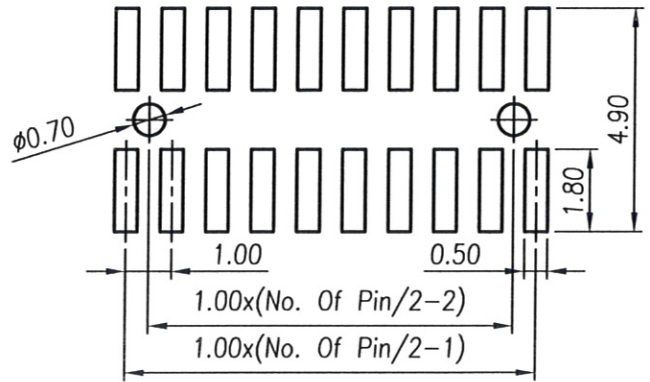

E

**RECOMMENDED PCB LAYOUT**  
(TOLERANCE:±0.05)



F

TOLERANCE UNLESS OTHERWISE SPECIFIED		PROJ.	TITLE: Female Header 1.00mm 180° H=2.05 DIP Dual Row			
.x± 0.35	x.'± 2'	APR. Jay 20130529	PART NO. ES033D1XX43TP		DWG NO. ES033D1XX43TP	
.xx± 0.25	.x'± 1'	CHK. Seven 20130529	UNITS: mm	CUSTOMER DRAWING		
.xxx± 0.15	.xx'± 0.5'	DRAW. Michelle 20130529	SIZE: A4	SCALE 6:1	SHEET 1 / 1	REV A1 V

A

B

C

D

E

F